



**300°/s**

Industry-leading Wrist Joint Speed

**1800mm**

Extended Reach

**±0.05mm**

Repeatability

**IP65**

Rugged Protection

# CR 30H

## Next-gen Flagship Cobot

**Industry's Fastest 30kg  
Cobot for Peak Productivity**

# DOBOT CR 30H Born Powerful

Industry's Fastest 30kg  
Cobot for Peak Productivity

**H**igh-Speed

**H**igh-Performance

**H**igh-Stability



**Strong** | High Performance

**30** kg Payload

Ideal for heavy-duty handling in food production, chemicals, logistics, and automotive.

**1800** mm Reach

Engineered for large-scale production and ideal for heavy-part handling and seamless multi-station workflows.

**Fast** | High Speed

**300** °/s Industry-leading Wrist Joint Speed

Precision Motion Control - Swift yet stable handling & palletizing.  
Boosted Efficiency - Maximizes production throughput.

**Stable** | High Stability

**Stable Operation under High Speed & Heavy Load**

Advanced vibration suppression and TrueMotion path correction ensure jitter-free precision at full-speed production.



## Next-gen Flagship Performance

Designed for high-end industrial automation, the CR 30H redefines heavy-duty collaboration with unmatched payload, speed, and stability. Its record-breaking 300°/s wrist joint speed—fastest in its class—delivers next-level productivity.



## Uncompromising Quality

With over 80,000 cobots deployed and 200,000+ customers worldwide, DOBOT delivers proven reliability through 160+ precision assembly steps and 200+ rigorous quality tests. Combining peak performance, productivity, and durability, we've become the trusted automation partner for manufacturers globally.

## Faster – Palletizing Power Unleashed, Productivity Doubled

### 300°/s Industry-leading Joint Speed



- Precision Motion Control – Swift yet stable handling & palletizing.
- Boosted Efficiency – Maximizes production throughput.

### Smarter Speed, Proven Results



- Equipped with HyperMove motion control that intelligently adjusts acceleration to maintain maximum reliable speed, delivering 20% higher single-unit efficiency than competitors.

### Palletizing/Handling Pace: 8-12 pcs/min



- Unlike the traditional palletizing system, the CR 30H solution can achieve new levels of automated palletizing performance.

\*Cycle time may vary based on product weight, dimensions, and gripping methods.

## More Reliable – Engineered for Uncompromising Performance

### High-Density Servo Drive Technology



- Equipped with a high-performance power engine and 96V mid-voltage servo drive technology, delivering 50% more power with 20% less heat generation.

### Optimized Joint Stability



- 30% fewer components for enhanced system reliability and significantly reduced downtime.

### Fail-Safe Electromagnetic Braking



- Equipped with a fail-safe electromagnetic brake that automatically activates in the event of a power outage, limiting the end effector displacement to near zero drop for maximum safety and precision.

### IP65 Rugged Protection



- Resists dust, water jets, and oil contamination.

## More Stable – Unmatched Stability under High Speed & Heavy Load

- A more stable mechanical design combined with advanced vibration suppression algorithms ensures smoother robot motion.
- TrueMotion high-speed path accuracy technology meets the demands of precision-critical applications.



## Smarter – Boosts Human-Robot Collaboration Efficiency

### One-Hand Drag-to-Teach



- Industry's first 30kg payload cobot with integrated torque sensors.
- Enables 90% faster programming with intuitive dragging.

### Shorter Control Cycle



- Higher control frequency enables faster response and more precise motion control.

### Detects & Brakes for Potential Collisions within 10 ms



- Advanced self-interference avoidance algorithm detects and stops potential collisions within 10 ms, minimizing risk of tool and robot damage.



## | Where Engineering Meets Elegance

- The streamlined joint design with cutting-edge technology ensures the efficient yet safe operation.
- 50% lighter than other industrial robots, effortless deployment for flexible manufacturing.



## | Compact and Lightweight

- With a 50% weight reduction compared to similar industrial models, the robot is highly compact, easy to deploy, and ideal for flexible manufacturing environments.



## | Quick Configuration, Intuitive Control

**Making Industrial Manufacturing Smarter and More Efficient**

- Blockly graphical programming, get started in just 30 minutes. Intuitive interface, easy operation for users of all skill levels.



## | International Quality Standards

**Powerful Performance, Uncompromising Quality, Total Peace of Mind**

- DOBOT's cobots have achieved global reach since 2015 - now with 50+ certifications across 40 economies and market access in 180 countries and regions.



**International Certification Standards**



**12/7 Global Support**



**Delivering Professional Technical Service Worldwide**



**90% In-House R&D Key Components**

# Heavy-Duty, High-Speed, Ultra-Stable Unlock Full-Scenario Productivity Across Industries



## Food & Beverage

Full-case palletizing and raw material handling solutions for dairy and frozen food production lines.

## Automotive

Automotive wheel hub handling, seat assembly, and battery module transfer, etc.

## Metal Processing

Handling of heavy-duty workpieces, welding, loading & unloading.

## Semiconductor

Wafer handling and packaging solutions.



## CR 30H - Standard

### Reliable Performance, Unmatched Productivity

- Unaffected by environment, doubling productivity.
- Unlocks full-scenario manufacturing potential.



## CR 30HT - Torque Sensor

### Intuitive Collaboration, Effortless Teaching

- Built-in joint torque sensors.
- One-hand drag-to-teach functionality.
- Instant collision detection response.



## CR 30H - Food-Grade

### Food-Safe Automation Certified

- NSF International certified components.
- Food-grade lubricant.
- Rinse directly with water, easier to clean.

## Product Specifications

Robot Body		
Weight		100 kg
Max. Payload		30 kg
Reach		1800 mm
Joint Range	J1/J2/J4/J5/J6	± 360°
	J3	± 163°
Max. Joint Speed	J1/J2	150°/s
	J3	200°/s
	J4/J5/J6	300°/s
End IO	Power Supply	0/12/24V, 2A(avg), 3A(max)
	Connector 1	2DI + 2DO + RS485
	Connector 2	2DI + 2DO
Repeatability		± 0.05 mm
IP Rating		IP65
Noise Level		70dB(A)
Operating Temp		0 ~ 50°C
Mounting		Floor/Wall/Ceiling
Cable Length		6 m (Body to Cabinet)
Materials		Aluminum Alloy/ABS/Rubber

Control Cabinet		
Dimensions		400 mm × 190 mm × 400 mm
Weight		19 kg
Power Input		200-240V AC, 50/60Hz
IO Power		24V, 3A(max), 0.5A/channel
General I/O Interface	DI	Digital Input 24 channels (NPN/PNP)
	DO	Digital Output 24 channels (NPN/PNP)
	AI	Analog Input 2 channels, 0-10V/4-20mA
	AO	Analog Output 2 channels, 0-10V/4-20mA
Safety I/O Interface	SI	Safety Input 10 channels
	SO	Safety Output 10 channels
Communication Interface	Network Ports	2× Ethernet (TCP/IP, Modbus TCP, Ethernet/IP, Profinet)
	RS485 Port	1× (Modbus RTU)
	Encoder	1× ABZ incremental interface
Environment	Temperature/Humidity	0-50°C, ≤95% RH (non-condensing)
IP Rating		IP20 (Optional IP54)
Teaching Methods		Teach Pendant/PC/Android App



## End-Effector Flange Parameters

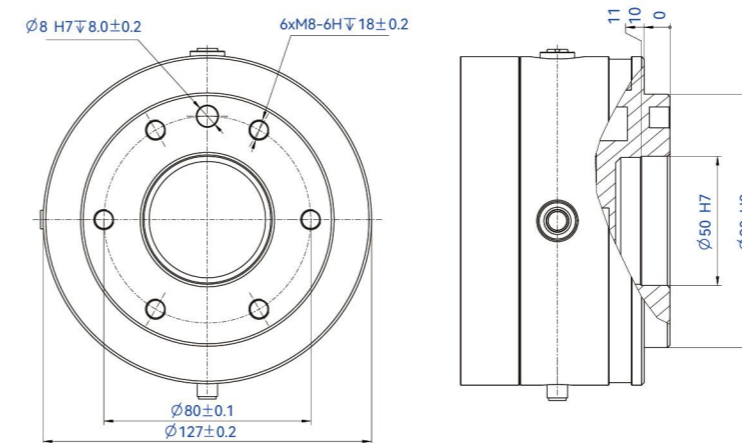

## Base Mounting Dimensions

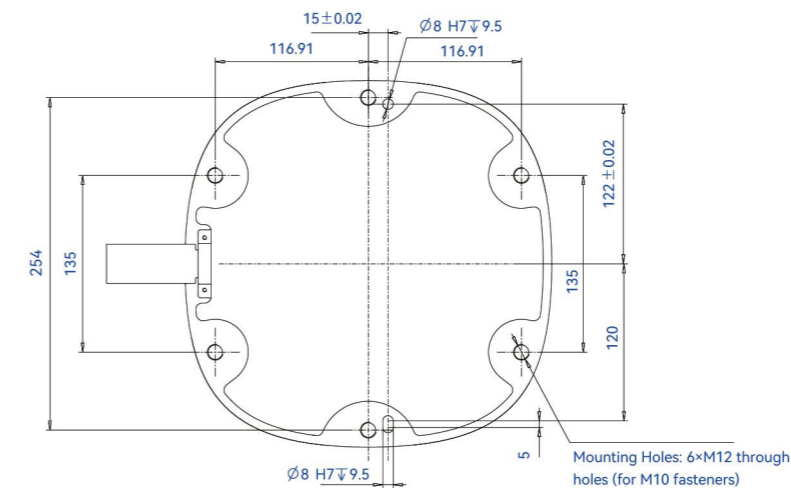

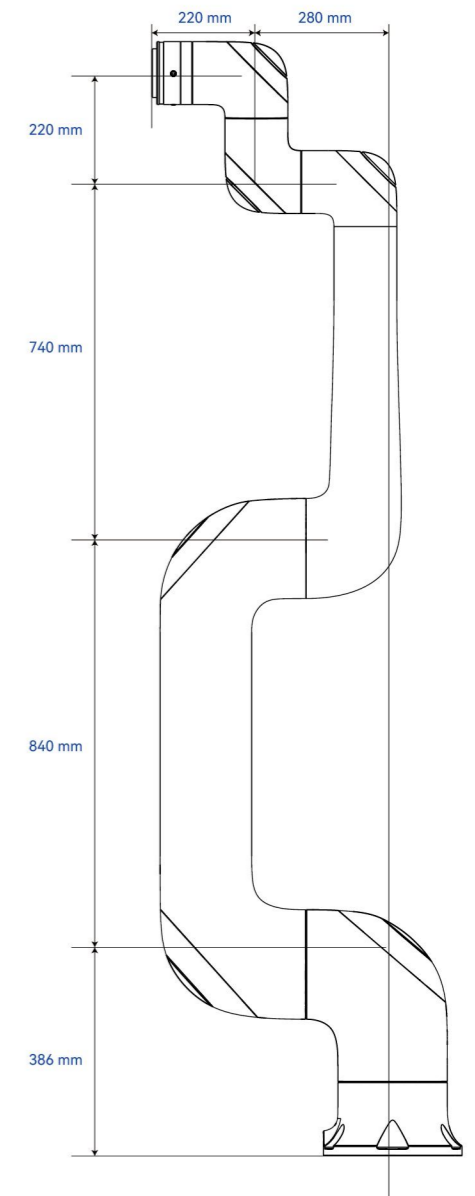

## Robot Body Parameters



Teach Pendant	
Dimensions	294 mm × 184 mm × 59 mm
Weight	1.09 kg
IP Rating	IP54 (Dust protected, splash proof)
Cable Length	4.5 m (Controller to Cabinet)
Display Size	10.1 inches
Display Resolution	1900 × 1200@60Hz
Memory	4GB RAM + 32GB Storage



-  [www.dobot-robots.com](http://www.dobot-robots.com)
-  [sales@dobot-robots.com](mailto:sales@dobot-robots.com)
-  [www.linkedin.com/company/dobotrobotics/](http://www.linkedin.com/company/dobotrobotics/)
-  [www.youtube.com/@DobotRobotics](http://www.youtube.com/@DobotRobotics)
-  China | Germany | USA | Japan | Thailand | Malaysia



D20250710